

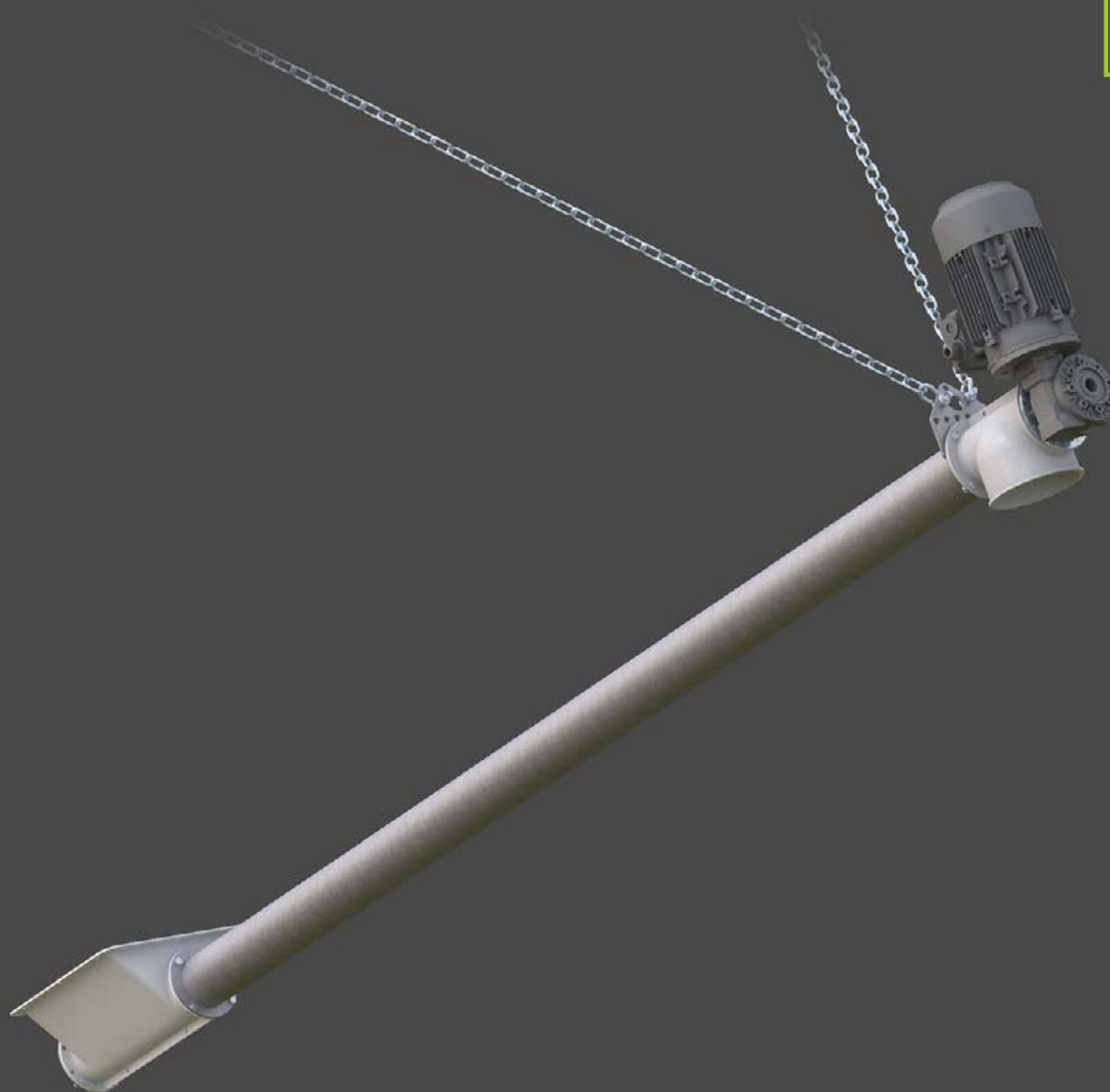

AGRO



Transport conveyors

TT 102, TT 127, TT 152, TT 205 and TT 254
with different inlet and outlet options



Transport conveyors

Tunetanken transport conveyors are specially developed for efficient transportation of grain and grinded materials such as flour, minerals, soybean meal, rapeseeds and beans. Transport conveyors can be used in both of two modes: horizontally or inclined at an angle up to 45°. Transport conveyor has a speed of 400 rpm as well as a flange pipe with a length from 3 to 12 meters.

Transport conveyors are available in different pipe diameters, respectively: in 102 mm, 127 mm, 152 mm, 205 mm or 254 mm. Transport pipes are manufactured in a custom length according to the customers' needs and wishes.

The flange pipes are put together using robust flange joints, which make the transport conveyor extremely durable.

Tunetanken transport conveyors are made of composite material as well as galvanized and stainless steel.

Different types of inlets and outlets made of fiber-reinforced composite material are available for the transport conveyor.

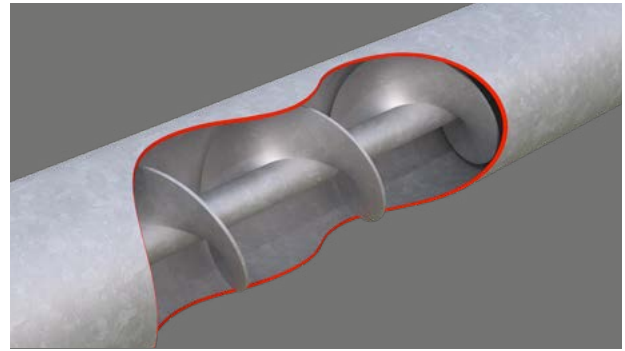

The inside of the transport conveyor.

Composite is a unique material, that is also used for the manufacturing of heavily strained products such as wind turbines, ships, aircraft, bridges etc.

Composite material ensures that the transport conveyors are chemically resistant, corrosion resistant and are easy to maintain.

Tunetanken transport conveyors are well thought out in terms of installation, operation, maintenance, life cycle and environment.

Benefits

1. Inlet in composite

An inlet in composite material is easy to clean due to smooth material surfaces. Furthermore, composite material has noise absorbing properties, a long life cycle and is chemically resistant.

2. Flange pipe

The flange pipe is made of galvanized steel. The flange pipe is extremely robust compared to sleeve coupling.

3. Conveyor

The conveyor is made of stainless steel and is available with a different inclinations, depending on the material to be transported.

Suspension

The transport conveyor can be suspended with a wire, a chain or with a fittings. It is important to provide the transport conveyor with support or to suspend it for every 6 meters.

4. Outlet in composite

The outlet is easy to clean due to the smooth material surfaces. The composite material has noise absorbing properties, a long life cycle and is chemically resistant.

5. Gear motor

The gear motor with 400 rpm requires minimal maintenance and has a long life cycle, if it is correctly maintained.

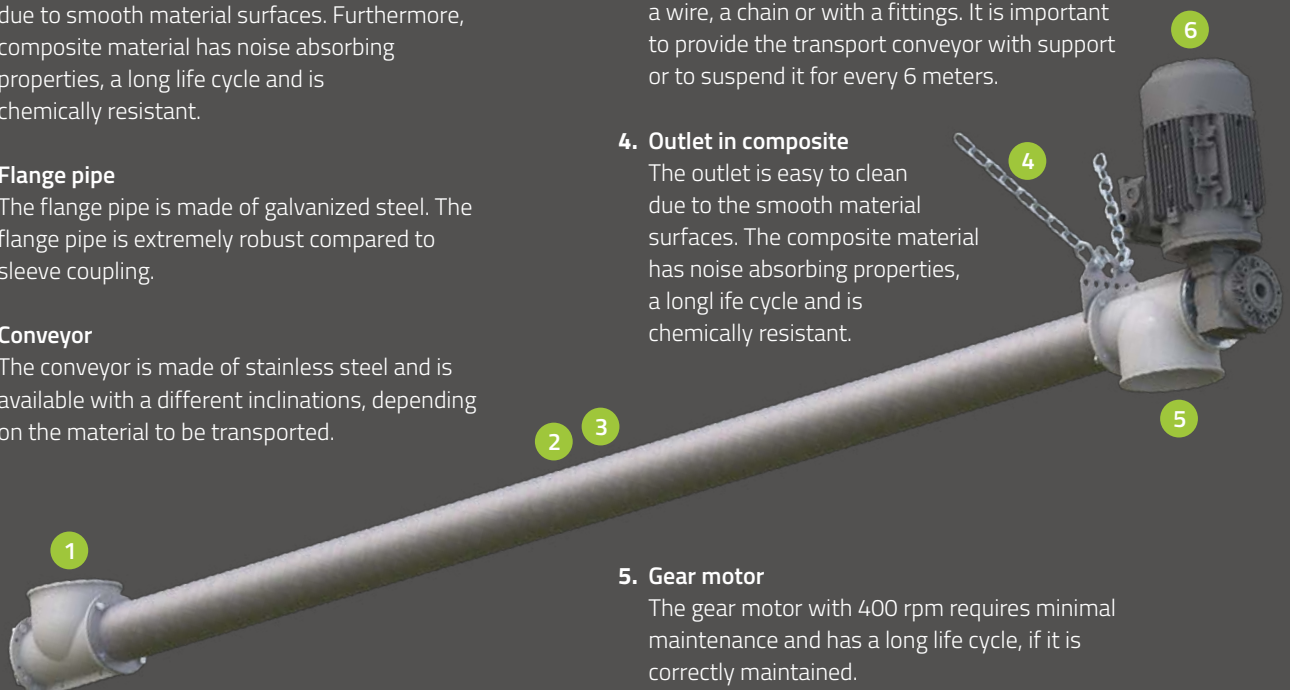



Transport conveyor mounted on an outdoor silo.

Benefits of Tunetanken transport conveyors

- > Inlet and outlet in composite.
- > Available with different types of inlets and outlets.
- > Composite parts are of great strength, have a long life cycle and are corrosion resistant.
- > Conveyor with 400 rpm.
- > Motor capacity from 1,5 – 5,5 kW.
- > Can be used in both of two modes: horizontally or inclined up to 45°.
- > Flange pipe varies from 3 to 12 meters in length.
- > Transport conveyors are available with different pipe diameters.

Options



Inlet 300 x 300
in composite material is sized and adapted according to the diameter of the flange pipe.



Inlet OK 160
in composite material is sized and adapted according to the diameter of the flange pipe.



Inlet Q 16
in composite is sized and adapted according to the diameter of the flange pipe.



Outlet OK 160
in composite is sized and adapted according to the diameter of the flange pipe.

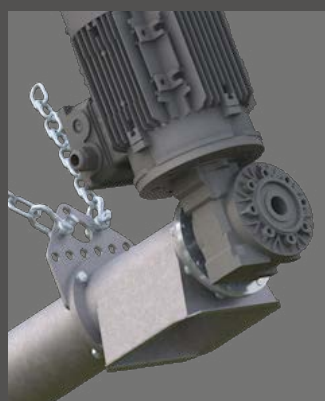

Outlet Q 16
in composite is sized and adapted according to the diameter of the flange pipe.



Tunetanken

With more than 50 years of experience in fiber-reinforced composite materials unique advantages and a large standard product programme we have developed our market position as the leading Danish manufacturer of storage tanks, industry systems and silos in composite materials.

Tunetanken markets a large and varied programme of products and facilities for various purposes as well as supplies a large range of industries including agriculture, industry, wastewater and water treatment for energy sector. We produce all our solutions in fiber-reinforced composite materials – the same materials that are used in the manufacturing of space shuttles, air planes and wind mills. With benefits as strength, corrosion resistance and long life cycle, composites are among the popular materials of the future.



Agro

Tunetanken offers a broad programme of products, facilities and systems for agriculture. We produce silos, tanks, airtight silos, grain handling systems, hay and grain drying systems, carcass covers, slurry systems, shelters, buildings, irrigation systems, barn inventory and more.

Most of our products are made with the incorporation of fiber-reinforced composite materials, which with their unique properties are extremely suitable for the demanding agricultural environment.

The modern composite materials are materials of the future. The innovative and unmatched technical material properties contribute greatly to the development of new sustainable products and solutions, which are necessary for a sustainable future.



Composit

Composite is derived from the Latin word »componere«.

Composite materials are made by combining two or more materials (physically not chemically), thereby creating a new material with specially intended and superior properties.

Technical properties of composite materials derive from the initial qualities and properties of the combined materials, the combination of the fabrics (matrix, reinforcement, hardener, additives), as well as, the production processes and conditions.

Possibilities are endless!